

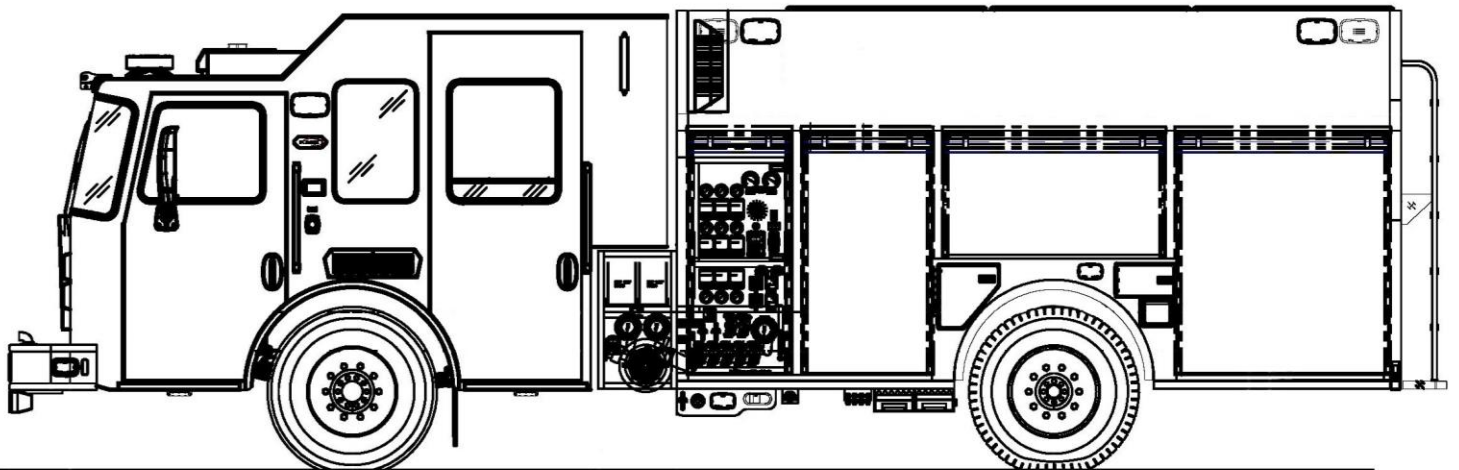

Napanoch (NY) Fire District PRO[®] Pumper

GSO 11484



CHASSIS

- KME XLFD four-door cab with 16-inch raised roof
- Cummins X15 engine; 565 HP, 1,850 ft-lb torque/Allison 4000 EVS transmission
- 110,000 PSI galvanized double-frame rails
- 4Front frontal impact air bags and Rolltek rollover air bag safety systems
- 22,000-pound Hendrickson STEERTEK from axle/suspension
- 31,000-pound Meritor rear axle with Hendrickson FireMaax suspension
- Bostrom 500 Series seating for eight
- 16-inch front bumper extension with discharge and storage well

BODY FEATURES

- 12-gauge 304L stainless steel extra-long formed body
- 29-inch deep full-height compartments both sides
- Full-length rooftop compartments
- Ladder, suction hose storage below hosebed

ELECTRIC & WARNING

- Smart Power 20 kW hydraulic generator
- Will-Burt NS Vertical 5.4-17 light tower with Whelen LED lights
- Whelen LED Scene Lights on all four sides of apparatus
- Whelen warning light package
- Federal Q2B siren

PUMP & PLUMBING

- 500-gallon poly water tank
- Hale DSD 1,500 GPM single-stage pump
- Trident automatic air primer
- Compact, enclosed pump panel
- (5) 2-1/2" discharges; (1) 3-inch discharge; (2) 1-3/4" speedlays; (1) 1-3/4" front-bumper discharge

SPECIALTY EQUIPMENT

- (2) CMW dual electric/hydraulic reels
- (1) Utility air reel
- Cascade air system with four 6,000 PSI ASME bottles
- Appleton Space Saver two-bottle SCBA fill station

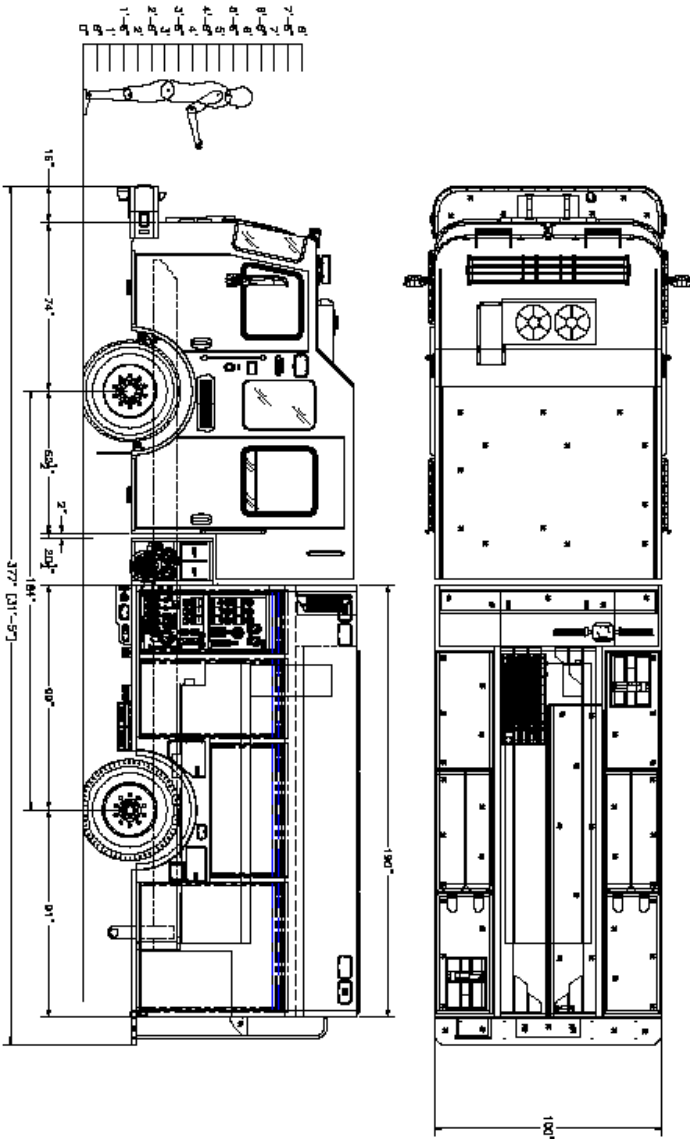
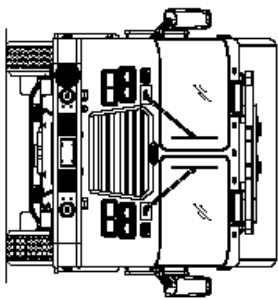
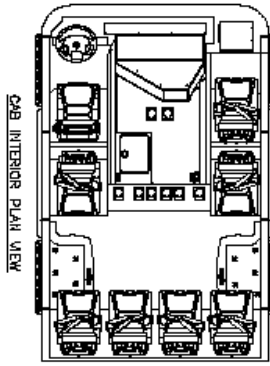
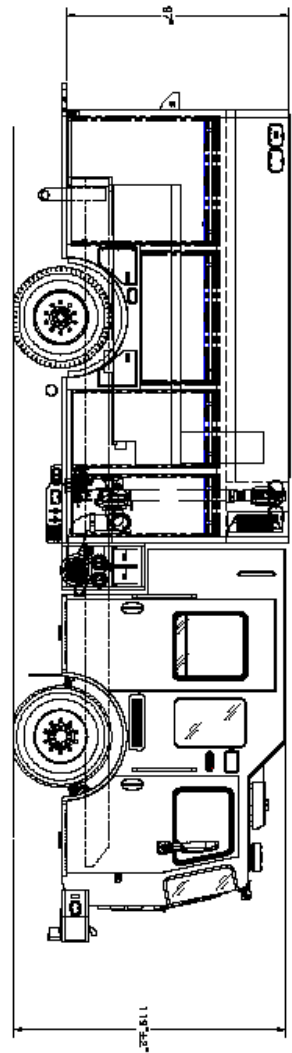
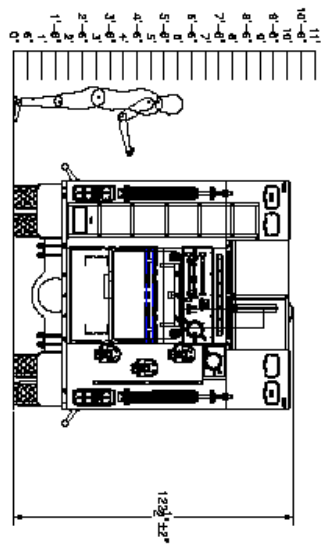

CAB: KME PREDATOR XL1D 16' RR
 ENGINE: IS TRAKS CUMMINS L5 565 HP/ALLISON 4000 EVS
 AXLES: 22 000 LB STEER/27 000 LB REAR
 PUMP: HALE OSD 1500 GPM SINGLE STAGE
 WATER TANK: 500 GALLONS POLY
 BODY TYPE: 192" PRO 304L STAINLESS STEEL

FOR INFORMATION ONLY
 THIS DRAWING IS A PRELIMINARY
 DESIGN AND IS SUBJECT TO CHANGE
 WITHOUT NOTICE. ALL DIMENSIONS
 SHALL BE IN UNITS OF INCHES UNLESS
 OTHERWISE SPECIFIED.

CUSTOMER APPROVAL:

NAME	
TITLE	
DATE	

SWI DATE REVISION DESCRIPTION
 RAJAB ENGINEERS : MAHMOUD

DESIGNED AND MANUFACTURED BY KME
 3000 E 10TH AVENUE
 DENVER, CO 80202
 PHONE: 303.751.1111
 FAX: 303.751.1112
 WWW.KME.COM
 KME CUSTOM PUMPER
 NAPANOGH, NY
 GSO# 11484

