

COMPARTMENT INTERIOR DIMENSIONS

COMP. HEIGHT	WIDTH	DEPTH
L1/R1 70	39-1/4 29/TRANS	
L2/R2 70	54-1/8 29/TRANS	
L3/R3 70	32	29
L4/R4 35-3/4	82-1/2	29
L5/R5 70	55-1/4	29

COMPARTMENT DOOR DIMENSIONS

COMP. HEIGHT	WIDTH	TYPE
L1/R1 66	36	ROLL-UP
L2/R2 66	52	ROLL-UP
L3/R3 66	30	ROLL-UP
L4/R4 35.5	58	ROLL-UP
L5/R5 66	52	ROLL-UP

NOTE: ALL DIMENSIONS ARE MEAS. UNLESS OTHERWISE NOTED.

CHASSIS: KME PREDATOR
CAB: PREDATOR XLFD 22" RR
ENGINE: CUMMINS ISL9 450HP
BODY: 5-COMPARTMENT ALUMINUM WALK AROUND
GENERATOR: HARRISON 15kw PTO/HYDRAULIC
PUMP: HAILE DSD 1500 GPM
TANK: 500 GALLONS
FOAM: 25 GALLONS

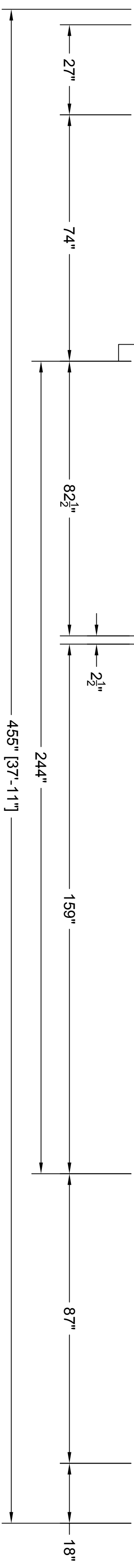
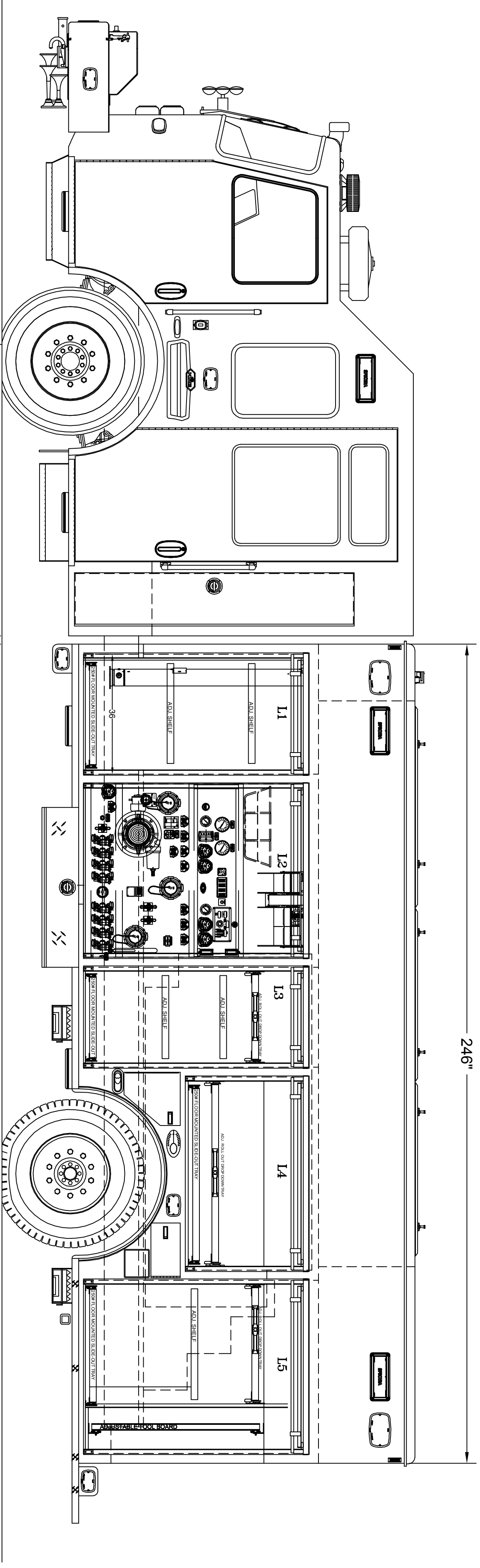
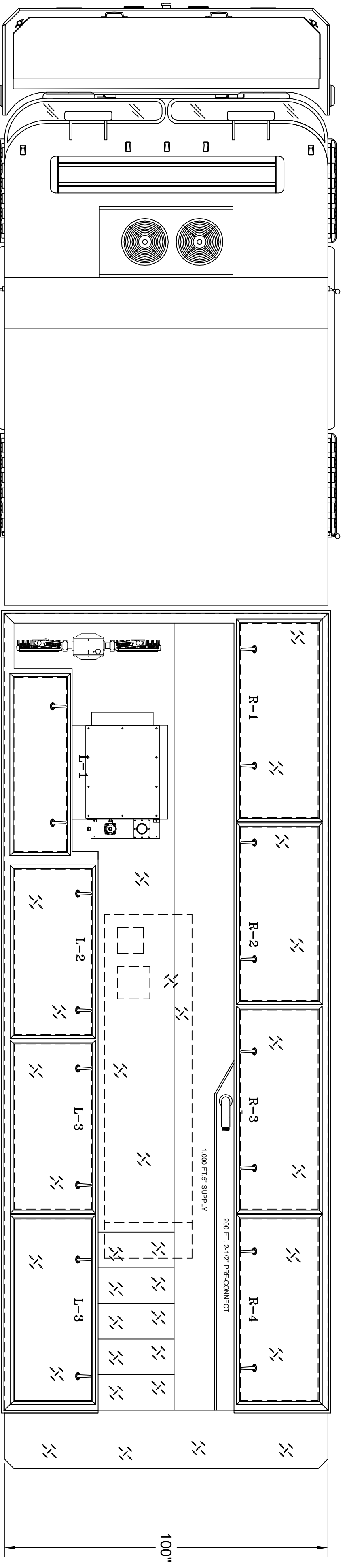
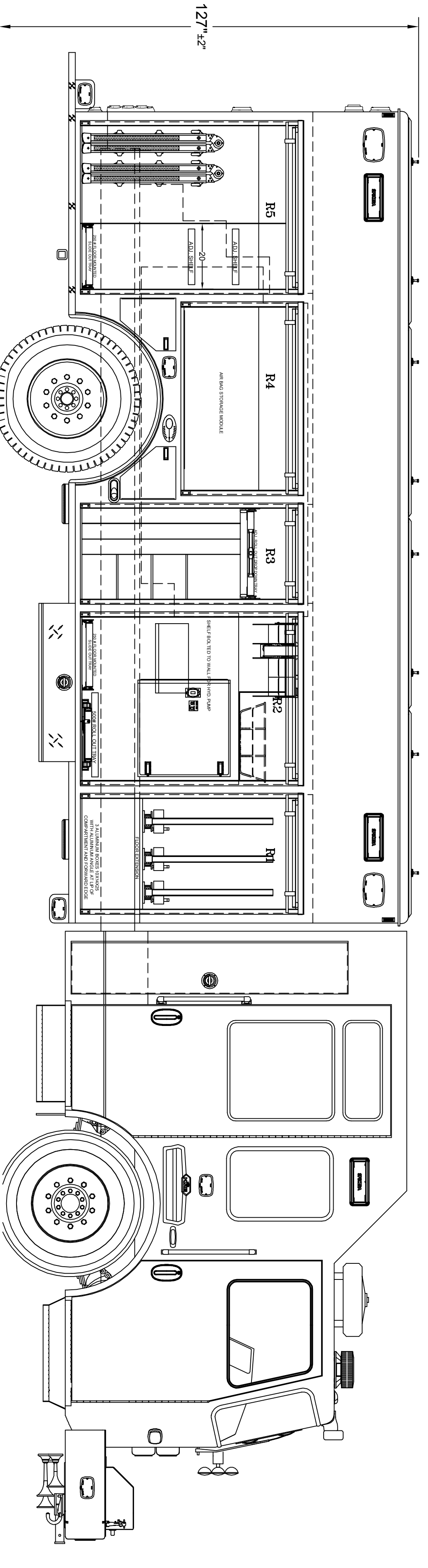

THIS DRAWING IS A GENERAL CONFIGURATION AND MAY NOT NECESSARILY REFLECT ALL CONTRACTUAL REQUIREMENTS. CONTRACT SPECIFICATIONS SHALL PREVAIL OVER DRAWING.

CUSTOMER APPROVAL:

NAME: _____
 TITLE: _____
 DATE: _____

SYM	DATE	REVISION DESCRIPTION	APP'D

SALES ENGINEER : JAMES MACHLING

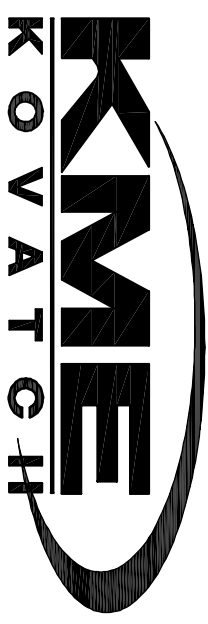

KOVATC H MOBILE EQUIPMENT
 ONE INDUSTRIAL COMPLEX - NESQUEHUNING, PA 18240

DIMENSIONS ARE APPROXIMATE & MAY VARY DUE TO BUILT ADJUSTMENTS
 SCALE 1"=30"
 DWG SIZE DRAWN BY JCM DATE 2/5/2015
 D APPROVED BY JCM

KME CUSTOM HEAVY RESCUE
PENNSVILLE, NJ
GSO# 10029